

All work on this page shall be supplied and performed by others at no expense to Entre Prises. Final determination of structural attachment is the responsibility of the Owners authorized representative (Engineer) and is not the responsibility of Entre Prises.

Refer to Structural Calculation Package by Froelich Engineering Consultants for reaction summary (supplied by Entre Prises).

Owner to supply (G25) Unistrut P31010-1/2" or compatible channel nuts with Unistrut columns.

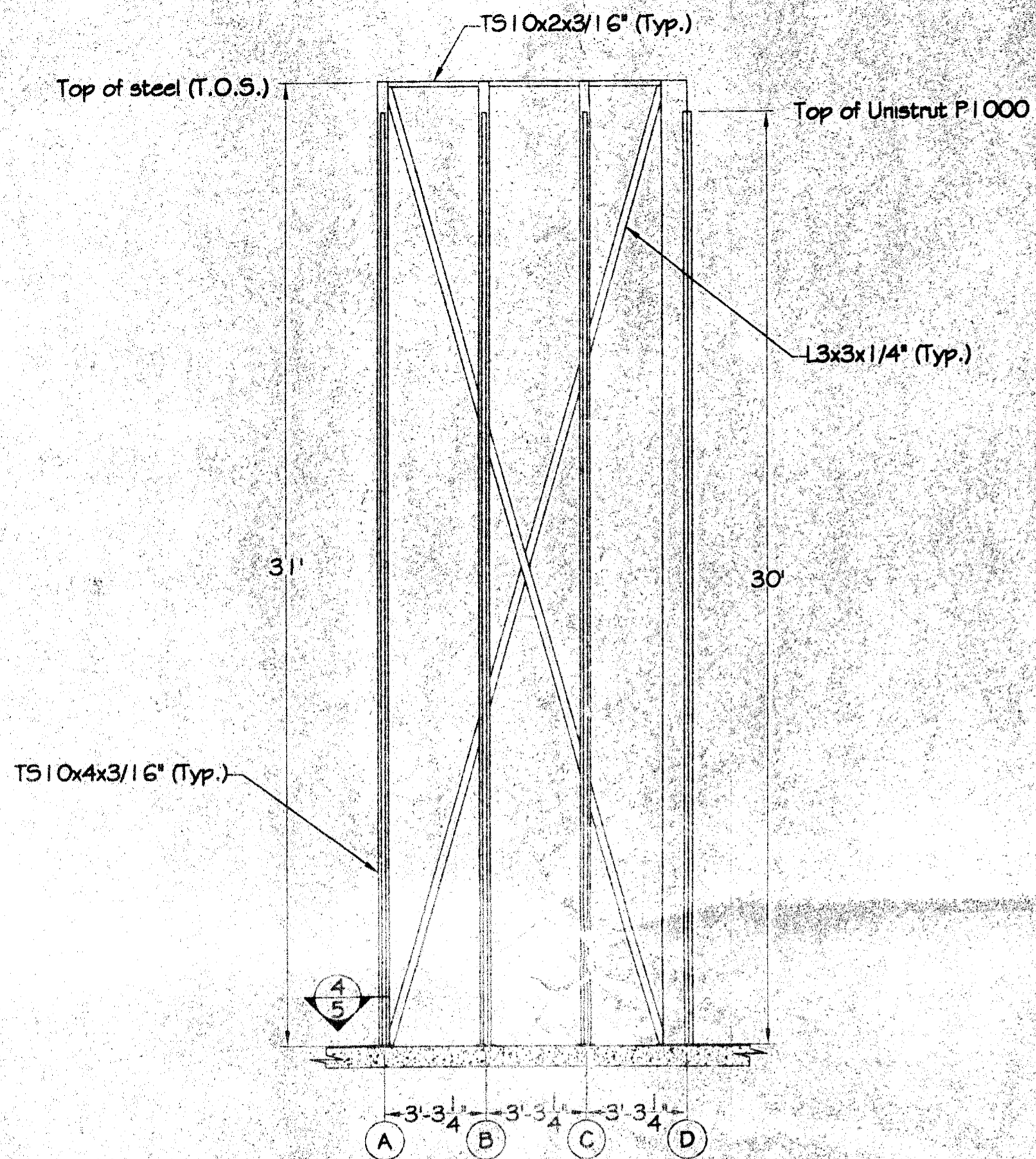

1/5 LEFT ELEVATION: Steel Column "A-D" Layout
Scale: 1/4" = 1'-0"

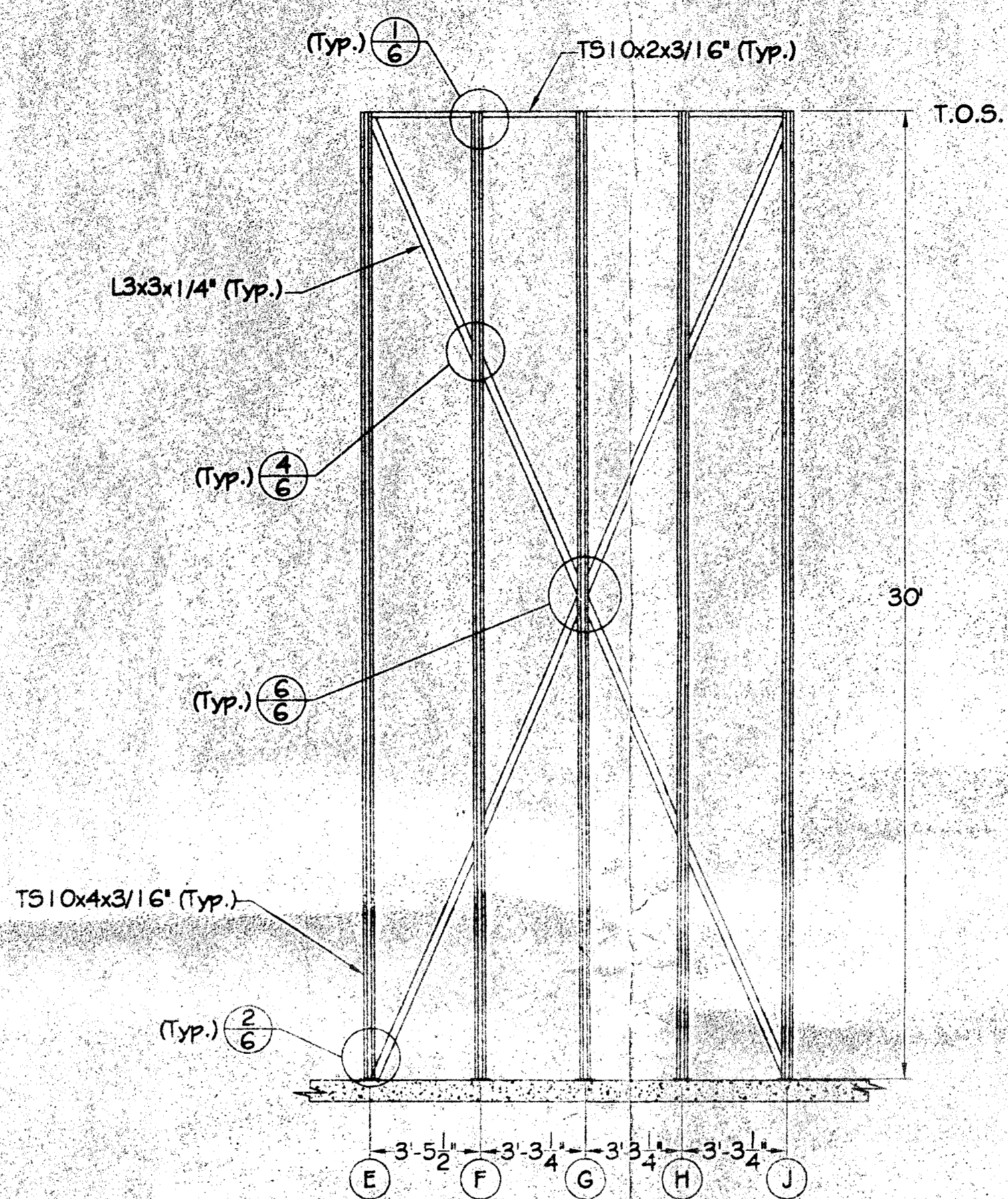

2/5 FRONT ELEVATION: Steel Column "E-J" Layout
Scale: 1/4" = 1'-0"

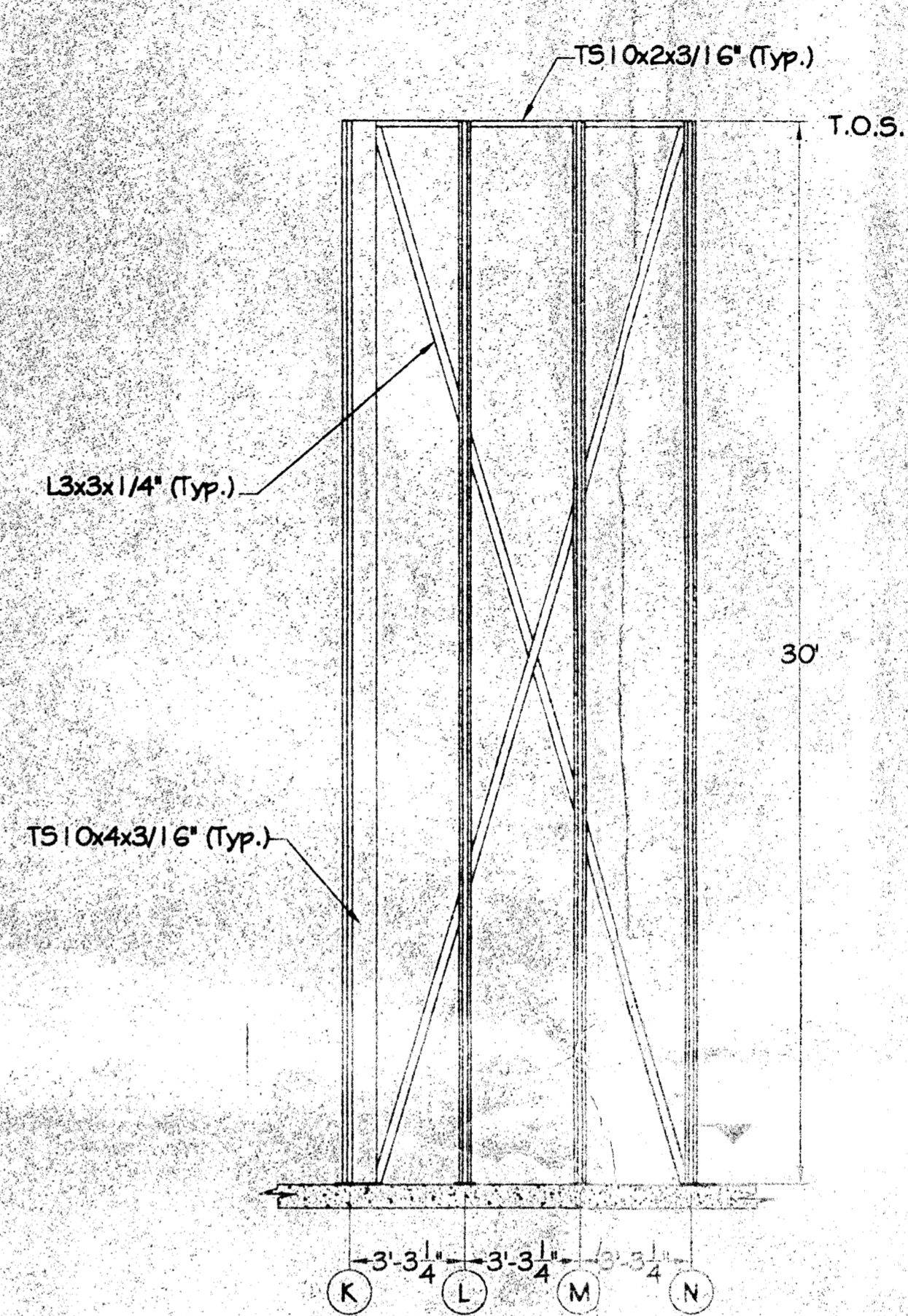

3/5 RIGHT ELEVATION: Steel Column "K-N" Layout
Scale: 1/4" = 1'-0"

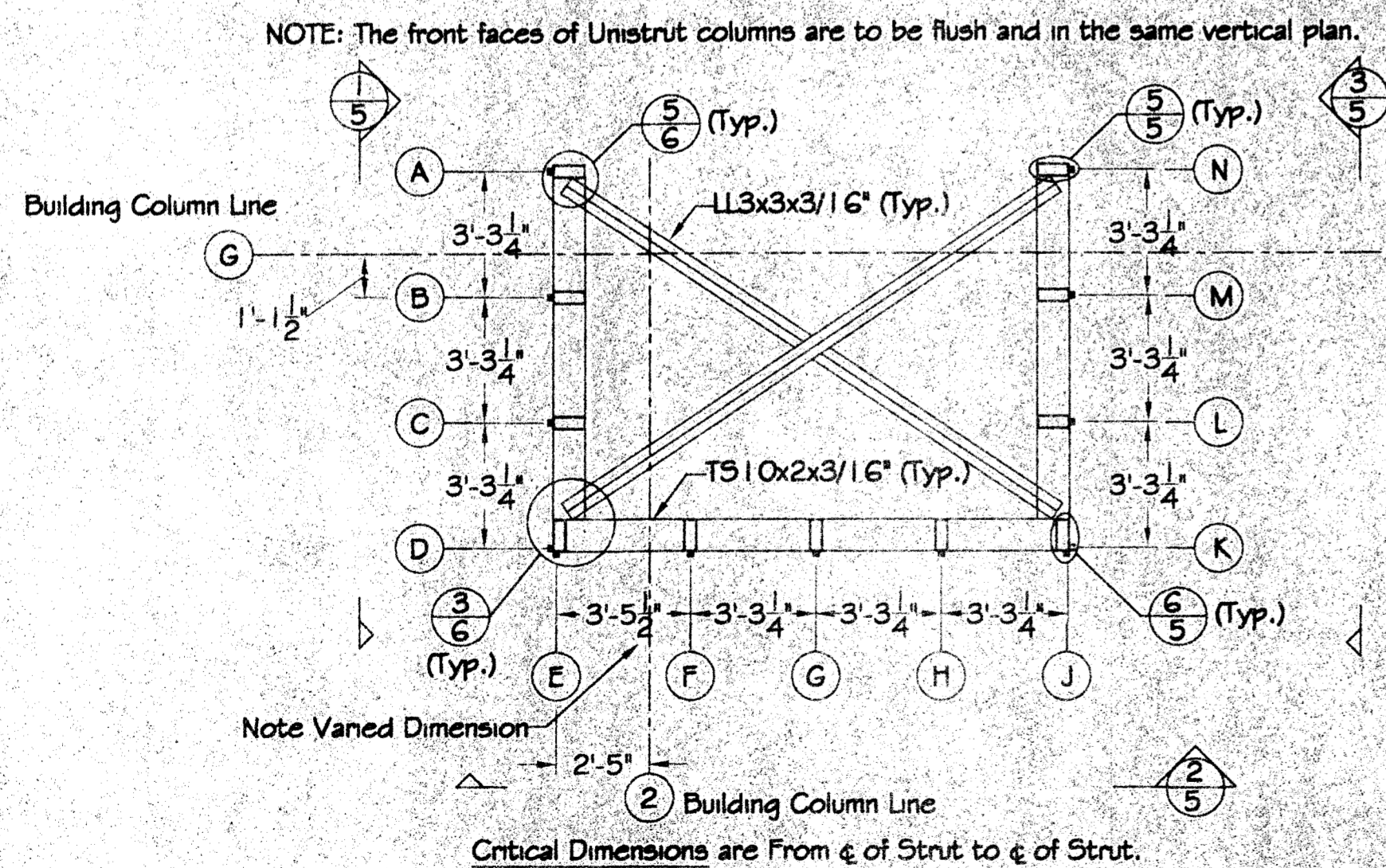

4/5 PLAN: Steel Column Layout
Scale: 1/4" = 1'-0"

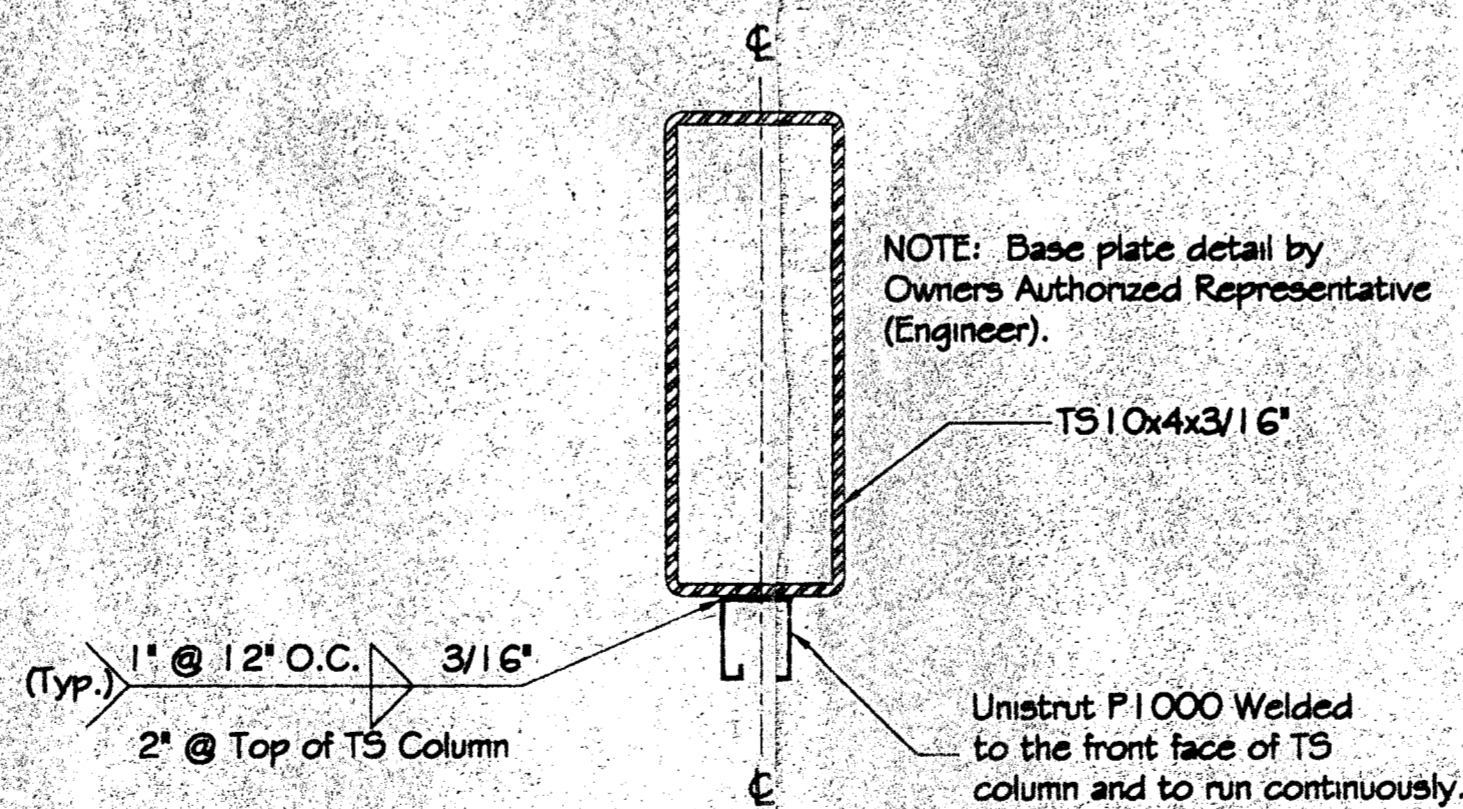

5/5 DETAIL: Unistrut Conn.
Scale: 3" = 1'-0"

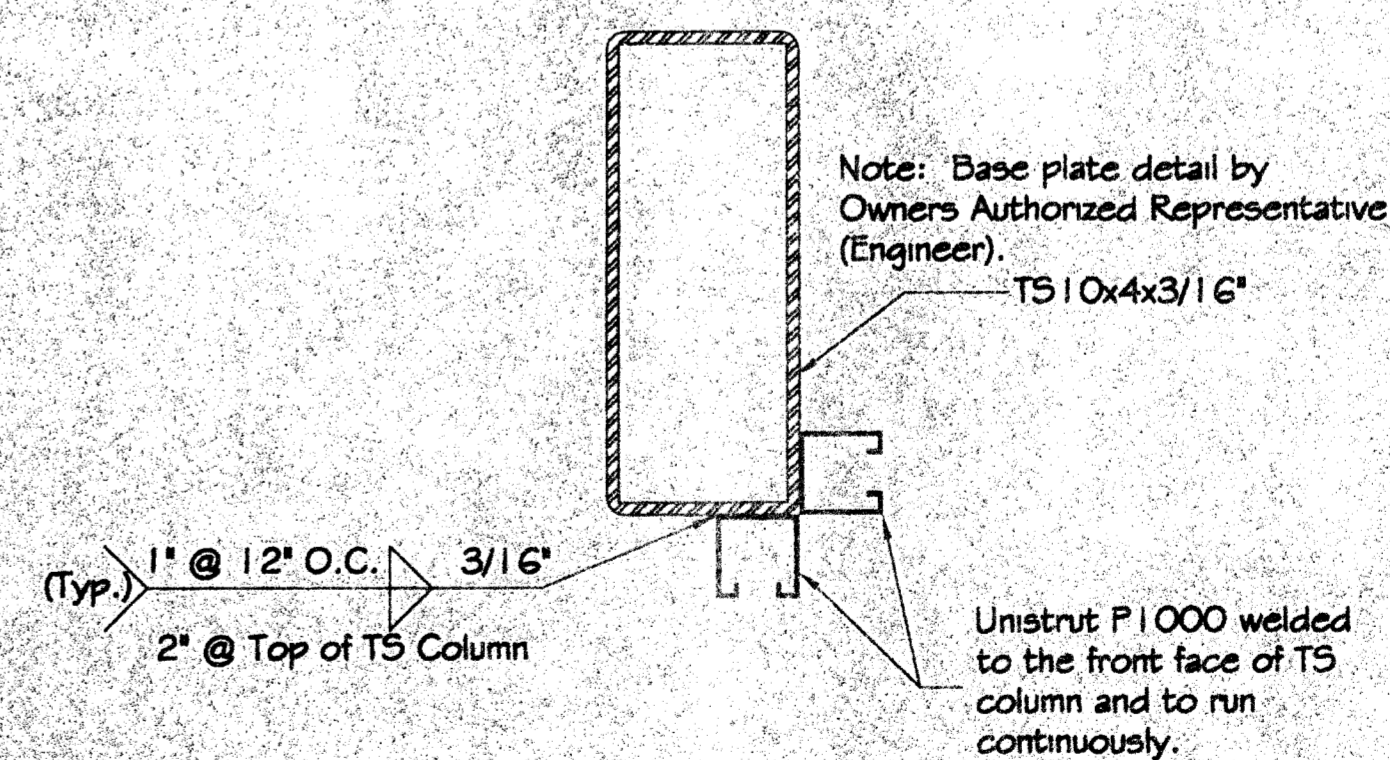

6/5 DETAIL: Unistrut Conn. @ Columns "D" & "K"
Column "K" shown, Column "D" offhand
Scale: 3" = 1'-0"

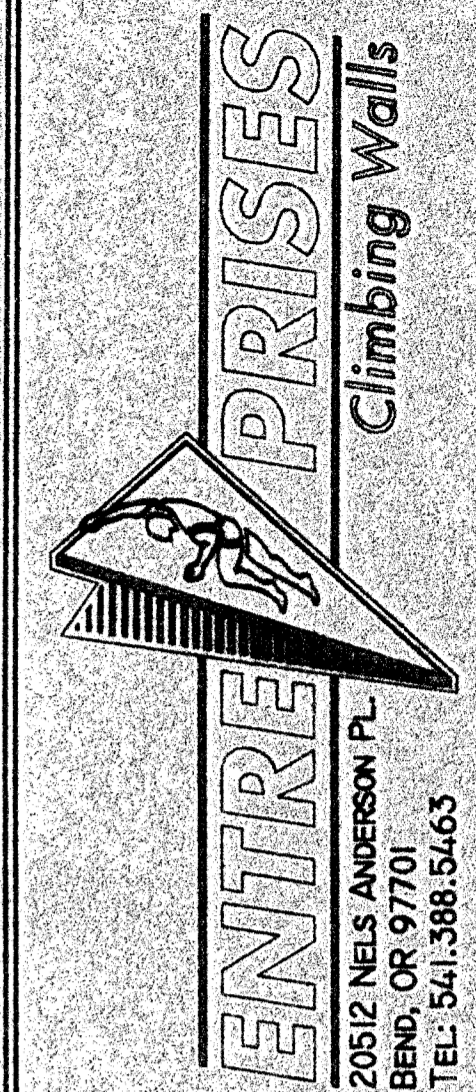

EP Job No: 1376
Date: October 28, 1998
DRN: MDJ
Checked: *[Signature]*

© Entre Prises USA, Inc. 1998 All rights reserved.
This work may not be used or reproduced in any form without the prior written consent of Entre Prises USA. The unauthorized reproduction or use of the work in any form or by any means may result in civil or criminal penalties.

United Sports Training Center
Boulder Drive
West Bradford, PA

Climbing Wall Installation Drws.
Main Wall
Steel Column Layout

DRW No: 1376-5

5 of 6